

SeaStarPRO outboard steering

SeaStar^{PRO}

premium outboard steering

The ultimate steering for high speed single outboards, SeaStar PRO[®], is designed for the high speed and performance of today's top-end bass boats. Recommended for single outboards up to 300 HP (even with jackplates and performance props), SeaStar PRO has steered the BASS Masters Classic[®] since 1994 and it's the choice of high performance outboard boatbuilders.

SEASTAR PRO[®]
FRONT MOUNT CYLINDER
OUTBOARD SYSTEM

Teleflex
pro
series

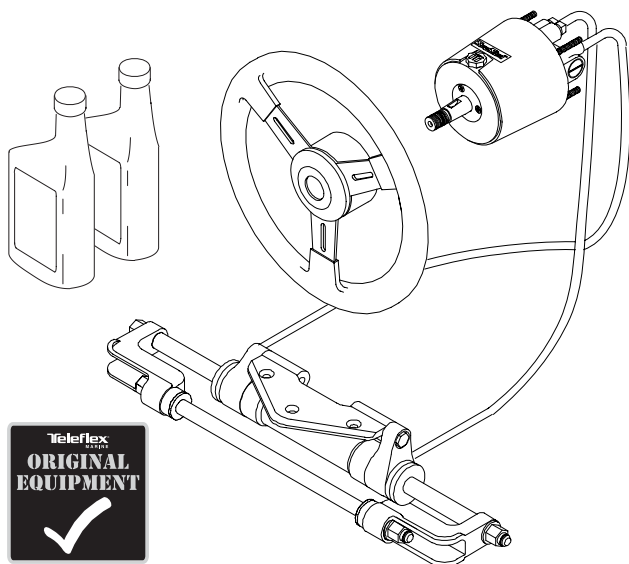

(4.25 turns lock-to-lock)

DIMENSIONS: pages 160-162
HOW TO MEASURE: page 84
SERVICE PARTS: pages 148-153
SUPPORT: www.teleflexmarine.com
or call 604-270-6899

NOTE: When properly installed, this steering system will connect to outboard engines with ABYC standard tilt tubes, using the engine's tiller arm (and possibly an adapter). Use only SeaStar PRO steering hoses (HO57 type, in 14, 16 & 18'). Do not use nylon tubing with SeaStar PRO. SeaStar PRO requires a balanced cylinder; do not use SeaStar PRO helms with unbalanced cylinders (side mount, splashwell mount, etc.) or steering will be very stiff in one direction. Always check clearances to ensure full engine articulation!

Applications:

Seastar Pro is for high-performance boats with single non-power-assisted outboards up to 300 HP, especially those capable of speeds over 60 MPH, which demand maximum steering control and comfort. It is suitable for use with high-performance propellers and jack plates.

SeaStar^{PA}
available!

Tilt[™]
STEERING
available!

Features:

- Patented steering lock valves.
- Low friction hydraulic steering system.
- 4.25 turns from lock-to-lock.
- Compact helm has only a 4-7/16" footprint — needs only 3" dash hole (Tilt requires larger hole).
- Optional PRO Cylinders with longer shaft bushings and larger pivot bushings for an *even more solid feel!*
- Optional hoses with through-bulkhead fittings; multiple helm mounting options
- Factory swaged hoses are Kevlar[®] reinforced.
- Packaged complete with helm, cylinder, fittings, oil, bleeder kit and detailed instructions.
- Standard 3/4" tapered steering shaft.
- Fast, easy installation.
- Meets A.B.Y.C. standards.
- Meets N.M.M.A. certification requirements.

premium hydraulic outboard steering, front mount cylinder

Complete Systems:

SeaStar PRO Steering Kit (with Hoses).. HK73XX
(XX = length of included hose kit in feet.)

SeaStar PRO Steering Kit (no Hoses).... HK7400

PLEASE NOTE WHEN ORDERING: SeaStar PRO steering kits come with cylinder # HC5345. If your application requires the use of a cylinder other than HC5345, you will need to purchase all components separately (helm, hoses, cylinder, etc.)

Components:

SeaStar PRO Helm HH5770
Pivot Mount Outboard Cylinder (Black) .HC5345*
(See application guide for some engines which may require HC5347, HC5348 or HC5358.)

SeaStar PRO Hose Kit (2 hoses)HO57__
SeaStar Oil (1 Quart)..... HA5430 (x2)

Options:

SeaStar PRO Sport Tilt Helm/Mech. HH5290
SeaStar PRO Traditional Tilt Helm/Mech HH5774

Pivot Mount Cylinder (Silver)HC53__SIL
(Same part number as black cylinders except for "SIL" suffix. For cylinder applications, see those for HC53__ series in Application Guide on next page.)

Pivot Mount Cylinder — PRO (Black)HC63__
(Second two digits are the same as standard black pivot mount cylinders; for example, PRO equivalent of HC5345 is HC6345. For PRO cylinder applications, see those for HC53__ series in Application Guide on next page.)

Pivot Mt. Cylinder — PRO (Red) ... HC63__RED
Pivot Mt. Cylinder — PRO (Silver)....HC63__SIL
(Same P/N as black PRO cylinders except for "RED" or "SIL" suffix. For red or silver PRO cylinder applications, see those for HC53__ series in Application Guide on next page.)

SeaStar Round Bezel Kit HA5417
(Reduces helm protrusion by 3.75")

SeaStar Backplate Kit..... HA5418
(Reduces helm protrusion by thickness of dash and allows clean retrofit of SeaStar helm where following helms were previously installed: pre-1991 SeaStar, SyTen, and mechanical rotary steering.)

SeaStar 20° Dash Wedge Kit HA5419

PRO Bulkhead Hose Kit (2 hoses)HO82__
(Allows through-bulkhead installation without additional fittings.)

Service Items:

SeaStar Oil (1 Gallon) HA5440
Steering Wheel Locknut 747521

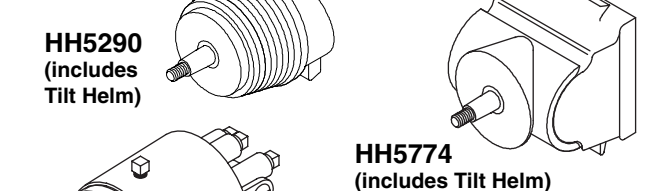
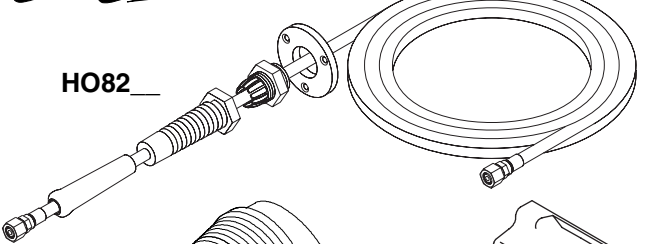
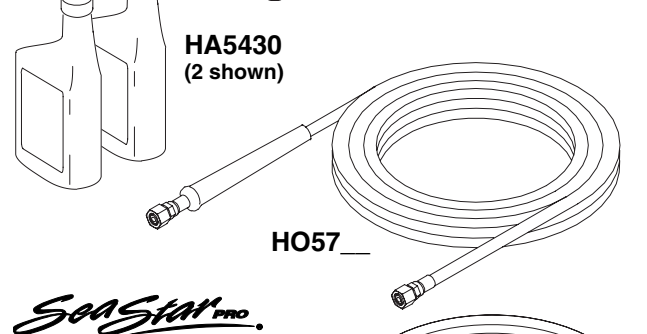
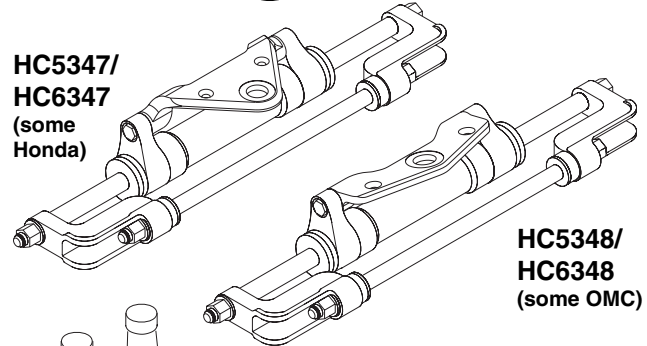
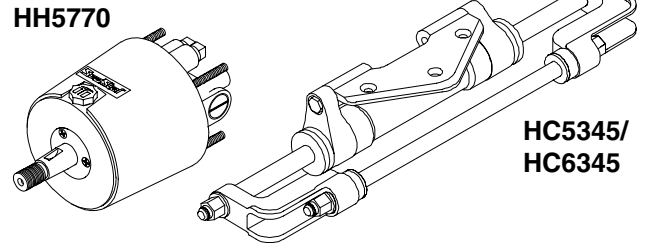

HYDRAULIC STEERING SeaStar PRO

SeaStarPRO outboard steering

SeaStar^{PRO} Application Guide

Teleflex
pro
series

ENGINE MAKER/ BRAND	YEAR	MODEL	CYLINDER PART NUMBER	NOTES
FORCE	1985-DATE	90-150HP	HC5345	
HONDA	1996-DATE	150-300HP	HC5345	
JOHNSON/EVINRUDE	1977-1990	150-300HP	N/A	Contact Teleflex.
	2002-DATE	150-250HP 4-Stroke	HC5345	
	2003-DATE	150-300HP ETech	HC5345	
	2005-DATE	E250HP Vindicator	N/A	Contact Teleflex.
MERCURY/MARINER	1989-DATE	150-300 2-Stroke, 4-Stroke and XS Engines	HC5345	XS engine requires Mercury-supplied tiller bolt on install.
SUZUKI	1986-DATE	150-250HP 2-Stroke, 4-Stroke	HC5345	
YAMAHA	1986-DATE	150-250HP 2-Stroke, 4-Stroke	HC5345	
	2002-DATE	300 HPDI	HC5358	

SeaStar^{PRO} Ordering Guide

Teleflex
pro
series

ENGINE/CYLINDER CONFIGURATION	COMPONENT DESCRIPTION	QTY. REQ'D	MODEL	PART NO.
SINGLE ENGINE (SINGLE CYLINDER) Applications up to 300 HP maximum NUMBER OF TURNS: 4.25	CYLINDER (see Application Guide)	1	PIVOT FRONT MOUNT	HC_3__
	HELM	1	SEASTAR PRO	HH5770
	HOSE KIT	1	SEASTAR PRO HOSE	HO57__
	OIL	3	SEASTAR OIL (QT.)	HA5430
OPTIONAL EQUIPMENT	BACK PLATE KIT		(FRONT MOUNT HELMS)	HA5418
	20 DEGREE WEDGE		(FRONT MOUNT HELMS)	HA5419
	SPORT TILT HELM		SEASTAR PRO	HH5290
	TRADITIONAL TILT HELM		SEASTAR PRO	HH5774
	BULKHEAD HOSE KIT		SEASTAR PRO HOSE	HO82__
	SILVER CYLINDERS			HC53__SIL
	PRO CYLINDERS (available in red, silver or traditional black)			HC63__
POWER ASSIST PRO STEERING			PA1315	

NOTES:

SeaStar PRO is for single engine applications only.

The recommendations shown above apply to factory stock outboards only. Modified installations may require a higher capacity steering system. (Cylinder volume / helm displacement = number of turns.) If in doubt, contact Teleflex Canada technical service for assistance.

Some applications vary from what is depicted in this catalog. Always consult SeaStar manual for diagrams specific to your application.

Interference between the cylinder and boat can occur under certain conditions. Check installation thoroughly throughout the full range of movement for engine tilt and trim (and jack plate, if present).

For all SeaStar PRO outboard systems: use only SeaStar PRO Hose Kit Part No. HO57__ or HO82__, where last two digits equal length in feet.

premium hydraulic outboard steering, front mount cylinder

SeaStar PRO[®]

premium outboard steering

*SeaStar PRO — the
Choice for High Speed
Single Outboard Boats!*

High speed generates high torque loads.

High torque loads greatly increase your steering effort.

Hydraulic steering systems weren't generally used on high speed boats until the advent of SeaStar PRO.

In a traditional hydraulic system, the propeller feedback load will try to turn the steering wheel. Since hydraulic helms have lock valves, the wheel doesn't turn but pressure in that hydraulic line will increase as the pressure in the other line drops. When the wheel is turned *with* the load, there is a dead spot, which makes handling difficult in high speed boats.

SeaStar PRO changed all that and made this version of hydraulic steering the standard for high speed single outboard powered boats.

SeaStar PRO's unique valve system keeps pressures in the two hydraulic lines about equal, so the wheel feels solid and sure at all times.

SeaStar PRO is the only hydraulic steering system uniquely designed to give you maximum steering comfort and control of your high-performance bass boat.

SeaStar PRO has been installed on premium bass boats as original equipment for many years. It's the ideal upgrade for twin-cable mechanical steering.

