

# Teleflex Marine Mechanical Steering

MECHANICAL STEERING dimensions

## Performance Tilt Mechanisms

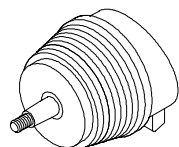

SH91500 PERFORMANCE TILT MECHANISM

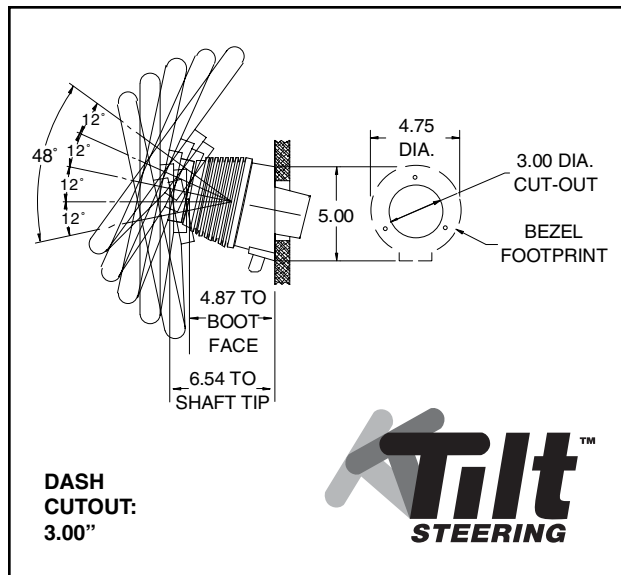

## Helm and Bezel Mounting Dimensions

### NFB Safe-T II



SAFE-T II (NO FEEDBACK) QUICK CONNECT (QC) STEERING SYSTEM  
APPLICATION DRAWINGS  
INCLUDES HELM, BEZEL AND CABLE

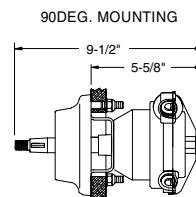
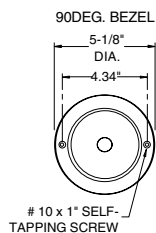
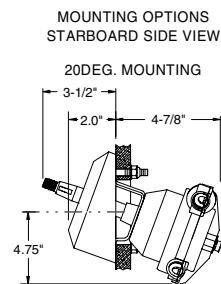
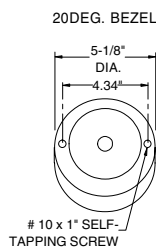
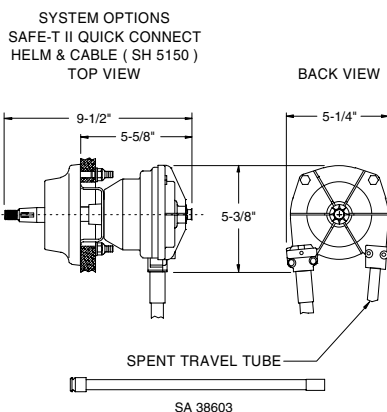

DIMENSIONS FOR TILT STEERING HELM

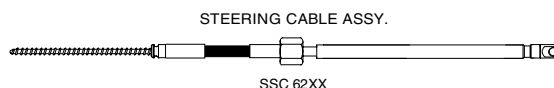
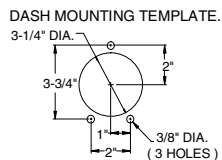
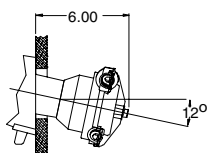

# NFB 4.2



**DASH CUTOUT:**  
STD: 3.25"  
TILT: 3.00"

## DIMENSIONS FOR TILT STEERING HELM

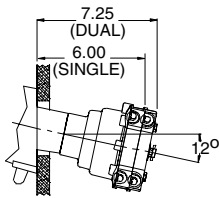

## 4.2 ROTARY NO FEEDBACK ( NFB ) STEERING SYSTEM APPLICATION DRAWINGS INCLUDES HELM , BEZEL AND CABLE

SYSTEM OPTIONS  
4.2 NFB SINGLE HELM & CABLE  
( SH 4910 )  
TOP VIEW

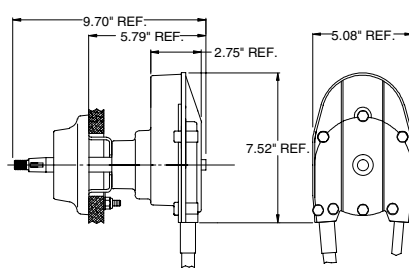

4.2 NFB DUAL HELM & CABLES  
( SH 4920 )  
TOP VIEW

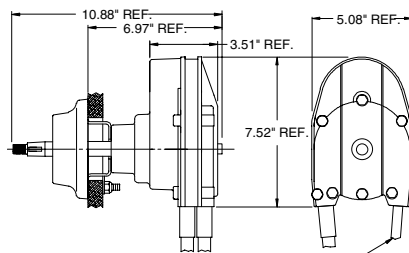

SPENT TRAVEL TUBE

SA 38603

20DEG. BEZEL

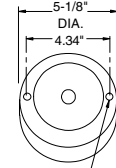

# 10 x 1" SELF-TAPPING SCREW

DASH MOUNTING TEMPLATE

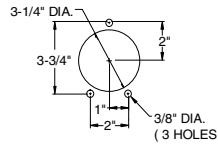

90DEG. BEZEL

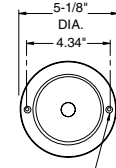

# 10 x 1" SELF-TAPPING SCREW

MOUNTING OPTIONS  
STARBOARD SIDE VIEW  
20DEG. BEZEL MOUNTING  
( SB 27483 )

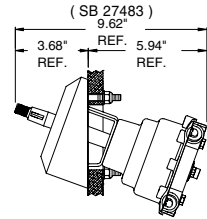

90DEG. BEZEL MOUNTING  
( SB 27150 )

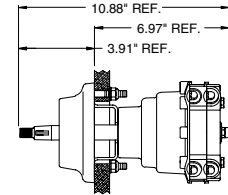

STEERING CABLE ASSY.

SSC 62XX

# HPS Rotary



**DASH CUTOUT:**  
STD: 3.25"  
TILT: 3.00"

## DIMENSIONS FOR TILT STEERING HELM

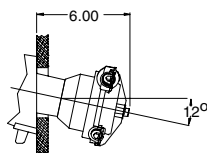

## HPS QUICK CONNECT ( QC ) STEERING SYSTEM APPLICATION DRAWINGS INCLUDES HELM , BEZEL AND CABLE

SYSTEM OPTIONS  
HPS QUICK CONNECT  
HELM & CABLE ( SH 5180 )  
TOP VIEW

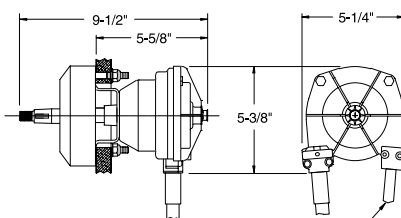

SPENT TRAVEL TUBE

SA 38603

20DEG. BEZEL

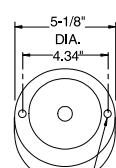

# 10 x 1" SELF-TAPPING SCREW

90DEG. BEZEL

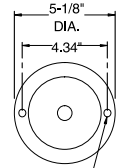

# 10 x 1" TAPPING SCREW

MOUNTING OPTIONS  
STARBOARD SIDE VIEW  
20DEG. MOUNTING

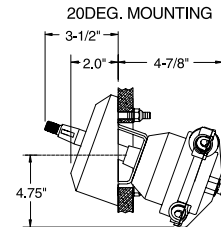

90DEG. MOUNTING

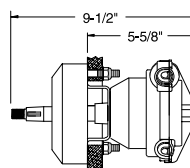

STEERING CABLE ASSY.

SSC 63XX

# Teleflex Marine Mechanical Steering

MECHANICAL STEERING dimensions

## Safe-T QC

**Teleflex**  
MARINE

### SAFE-T QUICK CONNECT (QC) STEERING SYSTEM APPLICATION DRAWINGS INCLUDES HELM, BEZEL AND CABLE

SYSTEM OPTIONS  
SAFE-T MOD II QUICK CONNECT  
SINGLE HELM & CABLE (SH 5094)  
TOP VIEW

BACK VIEW

MOUNTING OPTIONS  
STARBOARD SIDE VIEW

DASH  
CUTOUT:  
STD: 3.25"  
TILT: 3.00"

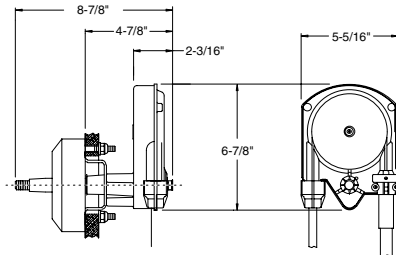

20DEG. BEZEL

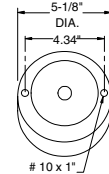

20DEG. MOUNTING

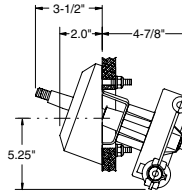

DASH MOUNTING TEMPLATE

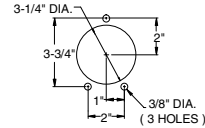

90DEG. BEZEL

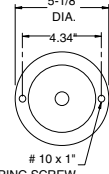

90DEG. MOUNTING

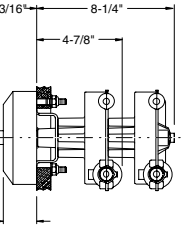

#### DIMENSIONS FOR TILT STEERING HELM

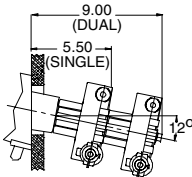

SAFE-T MOD II QUICK CONNECT  
DUAL HELM & CABLE (SH5294)

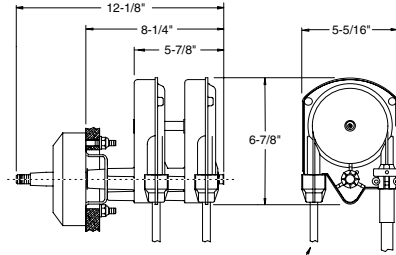

SPENT TRAVEL TUBE

SA 35680

STEERING CABLE ASSY.

SSC 62XX

## Big-T

**Teleflex**  
MARINE

### BIG-T STEERING SYSTEM APPLICATION DRAWINGS INCLUDES HELM, BEZEL AND CABLE

SYSTEM OPTIONS  
BIG-T HELM & CABLE  
(SH 5000)  
TOP VIEW

BACK VIEW

MOUNTING OPTIONS  
STARBOARD SIDE VIEW

DASH  
CUTOUT:  
STD: 3.50"  
TILT: 3.00"

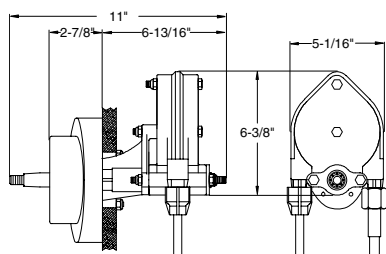

TWO-PIECE BEZEL  
(WHITE SB 27263)  
(BLACK SB 27265)  
(CHROME SB 27267)

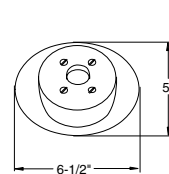

20DEG.  
TWO-PIECE BEZEL MOUNTING

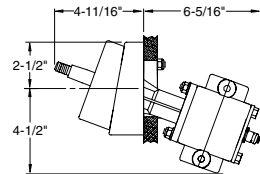

DASH MOUNTING TEMPLATE

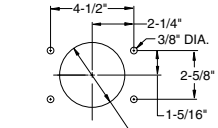

ONE-PIECE BEZEL (90DEG.)  
(CHROME SB 27268)

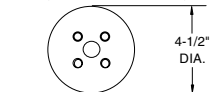

90DEG.  
TWO-PIECE BEZEL MOUNTING

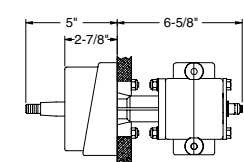

#### DIMENSIONS FOR TILT STEERING HELM

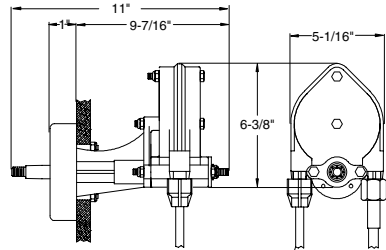
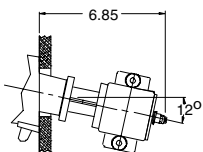

SPENT TRAVEL TUBE

SA 35680

STEERING CABLE ASSY.

SSC 72XX

## NFB Rack

### Pro Rack



**DASH CUTOUT:**  
STD: 2.25"  
TILT: 3.00"

**DIMENSIONS FOR TILT STEERING HELM**

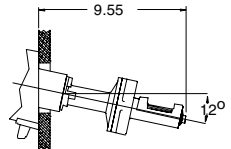

**NFB BACK MOUNT RACK STEERING SYSTEM APPLICATIONS DRAWING INCLUDES HELM, BEZEL AND CABLE**

**FRONT VIEW (W/O BEZEL)**

**BEZEL (90DEG. MOUNT) (BLACK SB 39544)**

**MOUNTING OPTIONS STARBOARD SIDE VIEW**

20DEG. BEZEL MOUNTING

**DASH MOUNTING TEMPLATE 90DEG. & 10DEG. MOUNT**

**DASH MOUNTING TEMPLATE 20DEG. MOUNT ONLY**

**WEDGE KIT**

20DEG. MOUNT (BLACK SB 27449)  
10DEG. MOUNT (BLACK SB 27448)

**STEERING CABLE ASSY.**

SINGLE SSC 134XX  
DUAL SSC 135XX

**SYSTEM OPTIONS**  
NFB BACK MOUNT RACK SINGLE / DUAL HELM (SH5230) & CABLE(S) TOP VIEWS

**P/N SSC134XX (NFB Rack single cable)**

**P/N SSC135XX (Pro Rack twin cable)**

Dimensions: 4-3/8", 8-5/16", 9-1/4", 19-1/4", 8" MIN. RAD., 4-1/2" DIA., 2.10", 2.60", 1.30", 1-13/32", 1-13/32", 1-5/8", 13/16", 5-16" DIA. (3 HOLES), 2-1/4" DIA., 4-5/8", 6-5/8", 1-33/64", 1-33/64", 1-7/8", 5/8", 2-1/4" DIA., 4-1/2", 7-5/8", 5-16" DIA. (3 HOLES)

## Back Mount Rack

### & hps Rack

High Performance Marine Steering

Featuring **TRACOR** Technology

*(HPS Rack is available in single-cable version only)*



**DASH CUTOUT:**  
STD: 2.25"  
TILT: 3.00"

**DIMENSIONS FOR TILT STEERING HELM**

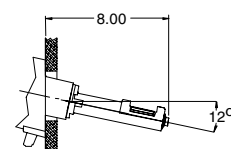

**BACK MOUNT RACK STEERING SYSTEM APPLICATIONS DRAWING INCLUDES HELM, BEZEL AND CABLE**

**FRONT VIEW (W/O BEZEL)**

**BEZEL (90DEG. MOUNT) (BLACK SB 39526)**

**MOUNTING OPTIONS STARBOARD SIDE VIEW**

20DEG. BEZEL MOUNTING

**DASH MOUNTING TEMPLATE 90DEG. & 10DEG. MOUNT**

**DASH MOUNTING TEMPLATE 20DEG. MOUNT ONLY**

**WEDGE KIT**

20DEG. MOUNT (BLACK SB 27449)  
10DEG. MOUNT (BLACK SB 27448)

**OPTIONAL FRICTION DEVICE 3953114**

**STEERING CABLE ASSY.**

SINGLE SSC 134XX  
DUAL SSC 135XX

**SYSTEM OPTIONS**  
BACK MOUNT RACK SINGLE / DUAL HELM (SH5210) & CABLE(S) TOP VIEW(S)

**P/N SSC134XX (single cable)**

**P/N SSC135XX (twin cable)**

Dimensions: 4-3/8", 6-1/2", 9-1/4", 19-1/4", 8" MIN. RAD., 4-1/2" DIA., 2.10", 2.60", 1.30", 1-13/32", 1-13/32", 1-5/8", 13/16", 5-16" DIA. (3 HOLES), 2-1/4" DIA., 4-5/8", 5-1/2", 1-33/64", 1-33/64", 1-7/8", 5/8", 2-1/4" DIA., 4-1/2", 5-3/4", 5-16" DIA. (3 HOLES)

# Teleflex Marine Mechanical Steering

MECHANICAL STEERING dimensions

## Jet Boat Steering



### JET BOAT STEERING APPLICATION DRAWINGS

TYPICAL CONNECTIONS AT NOZZLE:

Mercury Sport Jet

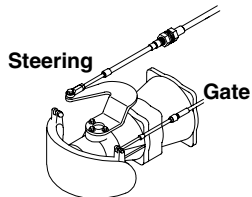

OMC Turbo Jet

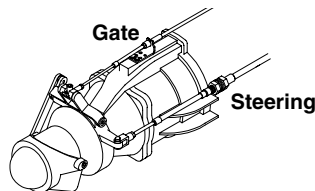

DASH CUTOUT:  
STD: 2.75"  
TILT: 3.00"

#### DASH MOUNTING TEMPLATE

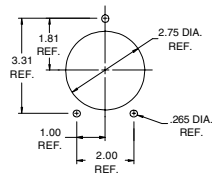

DIMENSIONS FOR TILT STEERING HELM

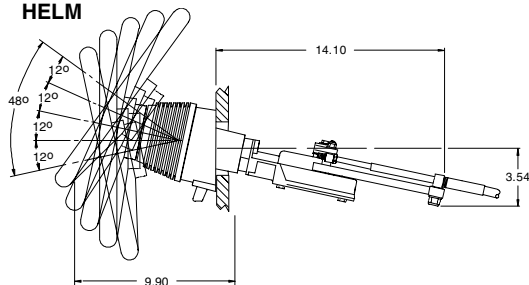

#### STEERING CABLE ASSEMBLY SSC219XX

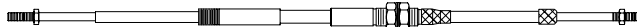

#### STRAIGHT CABLE MOUNTING (TOP VIEW)

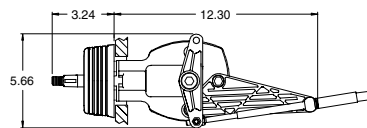

#### 90 DEG. CABLE MOUNTING (TOP VIEW)

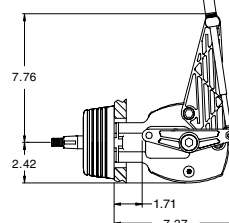

#### 90 DEG. BEZEL (SIDE VIEW) (FRONT VIEW)

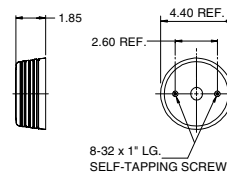

## Morse Command 290

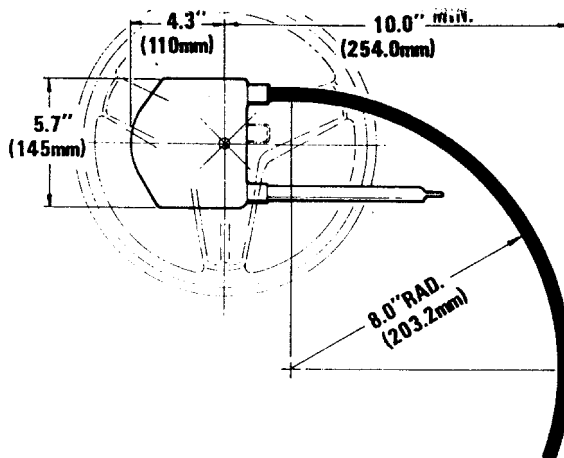

DASH CUTOUT:  
3.00"

