

HPS™ Rack & Pinion steering

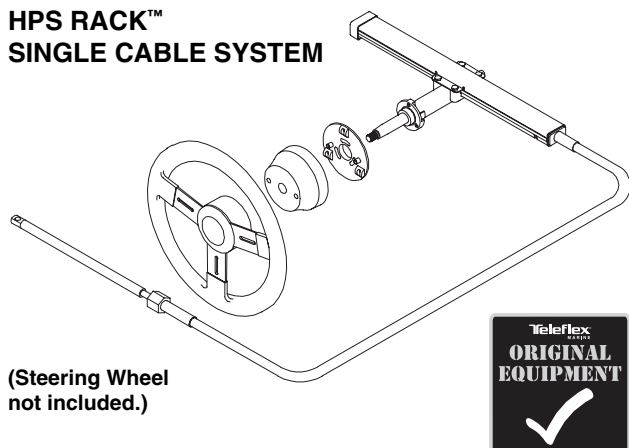

premium stern drive steering

HPS RACK™ SINGLE CABLE SYSTEM



Best System for Power-Assisted Steering (4 turns lock-to-lock)

**NEW VERSIONS OF TILT
COMING SOON!
(Contact Teleflex Marine
for Details.)**

NOTE: When properly installed, this steering system will connect to engines with ABYC standard tilt tubes, using engine manufacturer's link arm. For other engines, see Steering Connection Kits section for options.

HPS™ Rack by Teleflex is the best 4-turn way to steer a power-assisted stern drive or outboard! Ideal for small inboards too, HPS reduces backlash (free-play at the wheel) associated with power steered boats by up to 50%!

A great choice for ski boats, too!

Applications:

HPS™ Rack is ideal for all power-assisted stern drives that can accept a mechanical steering cable and have adequate room for a rack & pinion steering cable behind the dash.

It replaces most standard Teleflex and Morse Rack & Pinion steering without dash modifications.

HPS Rack is available in single cable configuration and is for single station use only. It accepts wheels up to 16" diameter.



Features:

- Designed for boats with power-assisted steering.
- Unique TFX™ core steering cable technology delivers *incredible response and minimal lost motion!*
- Precise, 4-turn response of Rack & Pinion steering.
- Designed to handle steering load in the event of power steering failure.
- Standard 3/4" round tapered steering shaft.
- Stainless steel cable output ends.
- Fast, easy installation: back mount design allows quick placement in dash *PLUS* mounting hardware fits industry-standard Teleflex and Morse rack holes.
- Meets A.B.Y.C. standards.
- Meets N.M.M.A. certification requirements.

mech. rack steering, most boats with power-assist steering

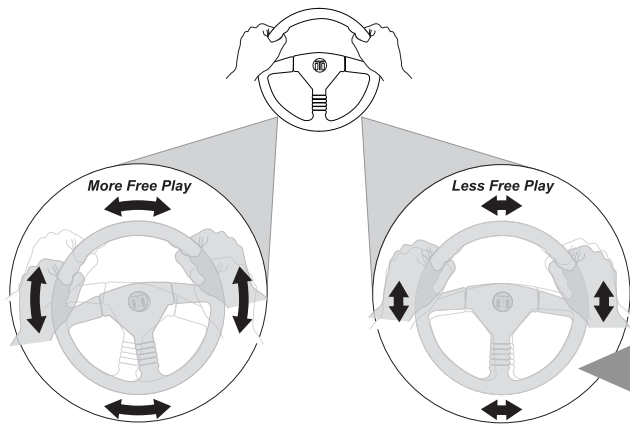

UP TO 50% LESS FREE-PLAY AT WHEEL VS. CONVENTIONAL STEERING.

Complete System:

This steering system is sold by components. Select helm, bezel and cable or Tilt helm, Tilt Mechanism and cable from items listed below.

Components:

Back Mount Rack Helm (single/dual) ..SH5210P

HPS Rack Single Cable.....SSC154XX
(XX = cable length in feet. A 14' SSC134 would be SSC15414.)

Back Mount Rack Bezel (90°)SB39526P

Options:

BM Rack Tilt Helm (single/dual) SH91610P*
* Requires SH91500 tilt mechanism to complete Tilt Steering system installation.

Performance Tilt MechanismSH91500P

Dash Wedge Kit (10°).....SB27448P

Dash Wedge Kit (20°).....SB27449P

Back Mount Rack Friction Device.....3953114P

Cable Gard (fits most tilt tubes)SA39329P

Service Items:

Steering Wheel Hardware Kit2745417P

SH5210P

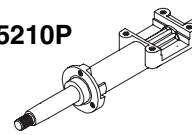

SB39526P

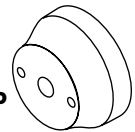

SSC154XX

(below: bottom view showing single cable)



SH91610P

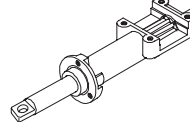

SH91500P

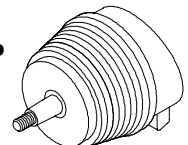

SB27448P

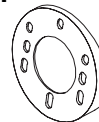

SB27449P

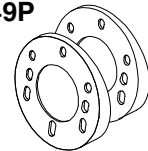

3953114P



SA39329P

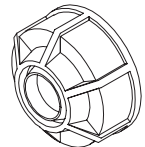

2745417P

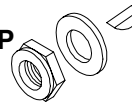

NOTE: Teleflex rack cable SSC154XX DOES NOT replace SSC124XX or any Morse Rack & Pinion cables and can only be used with Teleflex Rack & Pinion helms SH5210P, SH5230P, SH91610P & SH91630P.

NOTE: Please also note that while TFXTREME and other Teleflex Rack & Pinion cables are similar in appearance, they have completely different tolerances and performance characteristics. If you need assistance with these products, please call Teleflex Mechanical Tech Support at 610-495-7011.

