

HPS™ Rotary steering

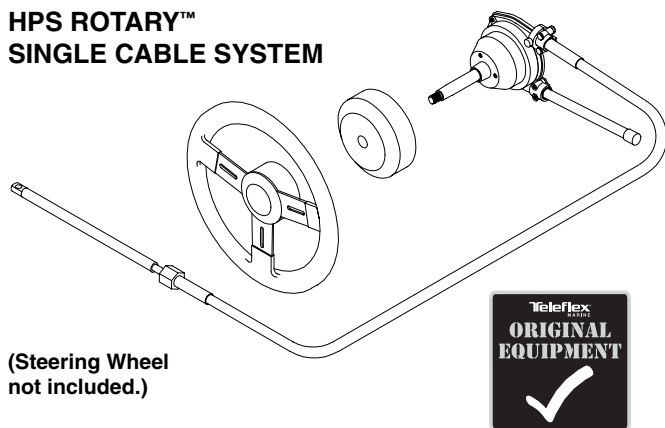

premium stern drive steering

HPS ROTARY™
SINGLE CABLE SYSTEM



(Steering Wheel
not included.)

Best System for Power-Assisted Steering (3 turns lock-to-lock)

**NEW VERSIONS OF TILT
COMING SOON!
(Contact Teleflex Marine
for Details.)**

NOTE: When properly installed, this steering system will connect to engines with ABYC standard tilt tubes, using engine manufacturer's link arm. For other engines, see Steering Connection Kits section for options.

HPS™ Rotary High Performance Steering by Teleflex is the best 3-turn way to steer a power-assisted stern drive! Designed exclusively for power-steered boats, HPS reduces backlash (free-play at the wheel) associated with power steered boats by up to 50%!

Applications:

HPS™ Rotary is ideal for all power-assisted stern drives that can accept a mechanical steering cable.

It replaces standard current generation Safe-T® steering without dash modifications and most other rotary steering systems with minimal dash modifications.

HPS Rotary is available in single cable configuration and is for single station use only. It accepts wheels up to 16" diameter.



Features:

- Designed *exclusively* for boats with power-assisted steering.
- Unique 3-turn helm with planetary gears and coated helical steering cable combine to deliver *a compact helm with incredible response and minimal lost motion!*
- HPS Rotary helms fit industry-standard Teleflex dash cutouts: either Safe-T/Rotary NFB™ or Tilt.
- Compact helm takes up little room behind the dash.
- Designed to handle steering load in the event of power steering failure.
- Standard 3/4" round tapered steering shaft.
- Stainless steel cable output ends.
- Fast, easy installation: uses Teleflex Quick Connect™ (QC) cable & standard Safe-T mounting hardware.
- Meets A.B.Y.C. standards.
- Meets N.M.M.A. certification requirements.



mech. rotary steering, most boats with power-assist steering

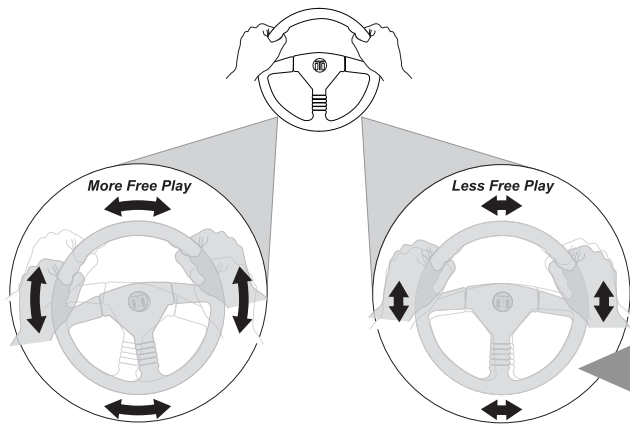

UP TO 50% LESS FREE-PLAY AT WHEEL VS. CONVENTIONAL STEERING.

Complete System:

This steering system is sold by components. Select helm, bezel and cable or Tilt helm, Tilt Mechanism and cable from items listed below.

Components:

HPS Rotary HelmSH5180P

HPS Rotary Cable (QC interface).....SSC63XX
(HPS cables require use of HPS helms. XX = cable length in feet. A 14' SSC63 would be SSC6314.)

Bezel (90°).....SB27484P

Options:

HPS Rotary Tilt Helm.....SH91650P*
** Requires SH91500 tilt mechanism to complete Tilt Steering system installation.*

Performance Tilt MechanismSH91500P

Bezel (20°).....SB27483P

Cable Gard (fits most tilt tubes)SA39329P

Service Items:

Steering Wheel Hardware Kit2745417P

Spent Travel TubeSA38603P

Hitch Pin for Quick Connect Helms2724514P

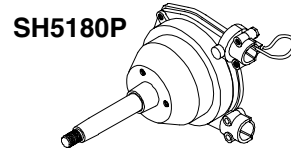

SSC63XX

SB27484P

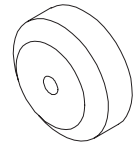

SH91650P

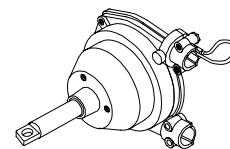

SH91500P

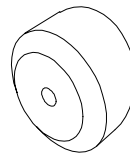
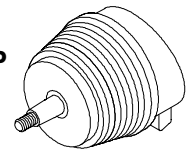

SB27483P

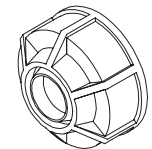

SA39329P

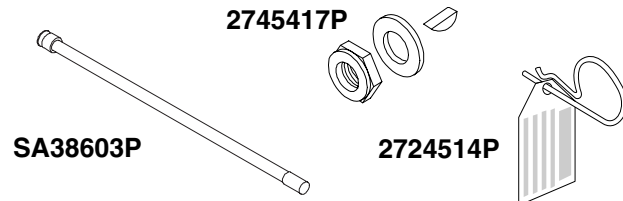

SA38603P

2745417P

2724514P

NOTE: Please also note that while HPS and Safe-T II helms and cables are similar in appearance, they have completely different tolerances and performance characteristics. HPS helms are gold in color for identification. HPS cables bear the "SSC63" part number. Do not substitute HPS for Safe-T II or vice-versa. If you need assistance with these products, please call Teleflex Mechanical Tech Support at 610-495-7011.

