

Helm Mounting Options & Tilt Steering:

Teleflex Marine offers a several helm mounting options to accommodate nearly any preference. These options are available for all helms, except as noted.

Please take a moment to familiarize yourself with these options before ordering replacement steering systems or components.

Helm Mounting Options:

Mechanical (cable) steering typically comes with 90° mounting hardware for the helm. (Steering shaft is perpendicular to dash).

20° mounting kits (steering shaft 20° from perpendicular) can be purchased as options.

Rack steering allows variations from 90° mounting in two settings: 10° and 20° from perpendicular.

Big-T has two bezel mounting options, a 2-piece oval bezel which can be configured in either 90° or 20° helm mounting plus a 1-piece 90° bezel which reduces shaft protrusion from the dashboard.

Tilt Steering:

Tilt Steering is an option for all mechanical steering systems. Tilt allows the wheel to be moved in 48° arc, in five 12° increments.

When ordering mechanical Tilt Steering, note that a special Tilt version of the helm must be ordered. Also, a Tilt Mechanism must be ordered.

Tilt helms are similar in appearance to standard mechanical helms, except for the steering shaft. Tilt helms have a flat ended shaft with a cross hole for connection to the "universal joint" in the tilt mechanism. (Standard helm shafts have a threaded end.)

Please also see the "Dimensions" section for more information.

MECHANICAL STEERING BEZEL MOUNTS: (typical)

TYPICAL BEZEL FOR 90° MOUNT
(steering wheel parallel to dash)



TYPICAL BEZEL FOR 20° MOUNT
(steering wheel 20° from parallel to dash)

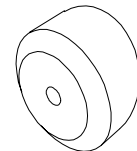

BIG-T 2-PIECE 90°/20° BEZELS:
SB27263P
SB27265P

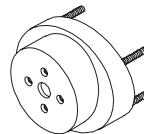

BIG-T 1-PIECE 90° BEZEL:
SB27268P

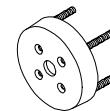

PERFORMANCE TILT (available for all Teleflex mechanical systems)

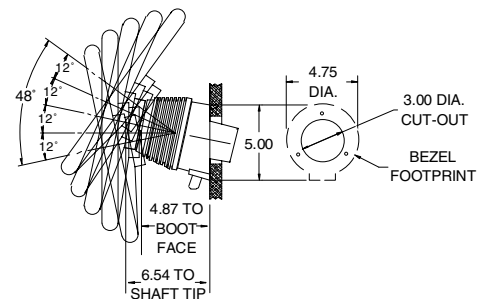

TILT STEERING MECHANISM
SH91500P
(requires purchase of tilt helm)

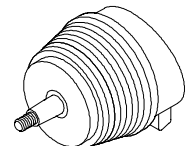

TILT HELM
(SH91650P shown)

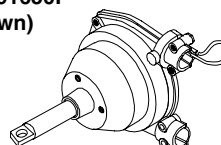

TILT HELM SHAFT DETAIL

