

NFB™ 4.2 Dual outboard steering

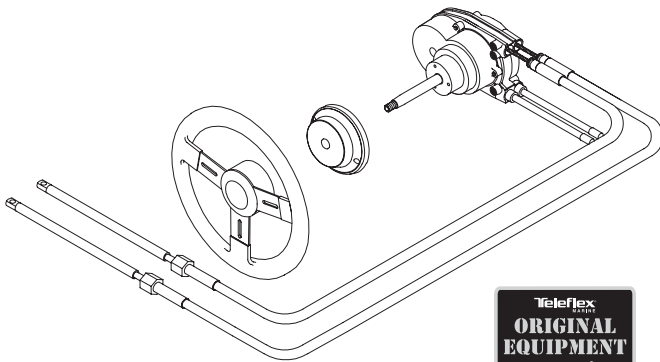

NFB™ 4.2 DUAL CABLE SYSTEM



(Steering Wheel
not included.)



(4.2 turns lock-to-lock)

**NEW VERSIONS OF TILT
COMING SOON!
(Contact Teleflex Marine
for Details.)**

NOTE: When properly installed, this steering system will connect to engines with ABYC standard tilt tubes, using engine manufacturer's link arm. For other engines, see Steering Connection Kits section for options. **NFB is not for use with power-assisted steering or autopilots.**

Patented No FeedBack Steering Control for about the cost of an old-fashioned steering replacement. With the advantage of 4.2 turns lock-to-lock and our patented No FeedBack steering to lock out steering loads, Teleflex's 4.2 Rotary NFB Steering is the ideal system for most non-power-steered boats. This rugged dual cable system is made for applications with engine flutter or steering instability. The helm is a drop-in replacement for current generator Safe-T with no dash modifications required.

(See preceding pages for single cable system.)

Applications:

NFB 4.2 dual-cable systems are suitable for most single-station boats with a single non-power-assisted outboard engine up to V-6 in which engine flutter or steering instability is present. 4.2 accepts wheels up to 16" diameter.

Replaces nearly all Teleflex Safe-T® steering systems (including twin cable) without dash modification.



Features:

- Patented No FeedBack™ Steering mechanism.
- Twin cable system for maximum control.
- Comfortable 4.2 turns from lock-to-lock.
- Minimal clutch free play.
- Standard 3/4" round tapered steering shaft.
- Stainless steel cable output ends.
- Fast, easy installation: uses Teleflex Quick Connect (QC) steering cable and industry-standard Safe-T mounting hardware.
- Kits include: 2 cables, helm, 90° bezel and hardware.
- Meets A.B.Y.C. standards.
- Meets N.M.M.A. certification requirements.

2-cable mechanical rotary steering, non-power-assisted boats

Complete Systems:

NFB 4.2 Dual Steering Kit
(Dual Cable) SS148XX

(Kits available with steering cable lengths from 12-16 feet. If either a longer or shorter cable is required, please order your system by components, which are listed below.)

NFB 4.2 DUAL CABLE STEERING KIT



Components:

NFB 4.2 Dual Helm.....SH4920P

QC Cable.....SSC62XX
*(XX = cable length in feet. A 14' SSC62 would be SSC6214.
NOTE: 2 cables are required with the NFB 4.2 dual helm.)*

Rotary NFB Bezel (90°).....SB27150P

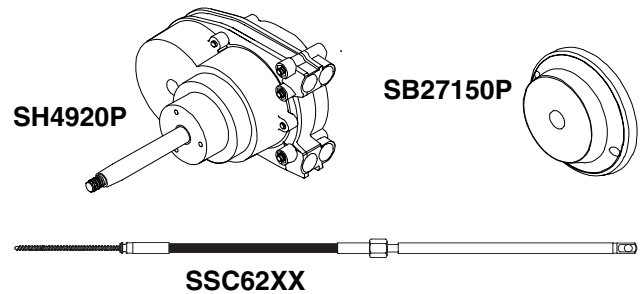

Options:

NFB 4.2 Dual Tilt Helm SH91527P*
** Requires SH91500 tilt mechanism to complete Tilt Steering system installation.*

Performance Tilt Mechanism.....SH91500P

Bezel (20°).....SB27483P

Cable Gard (fits most tilt tubes).....SA39329P

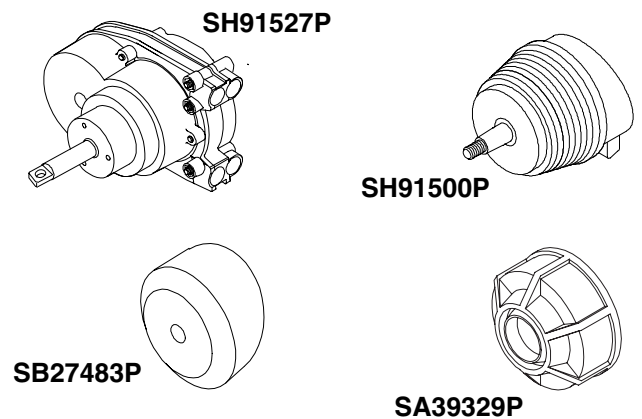

Service Items:

QC II Cable (for most Teleflex rotary)... SSC61XX
(NOTE: 2 cables are required with the NFB 4.2 dual helm.)

Steering Wheel Hardware Kit.....2745417P

Spent Travel Tube (Rotary NFB) SA38603P

