

NFB™ Pro Rack outboard steering

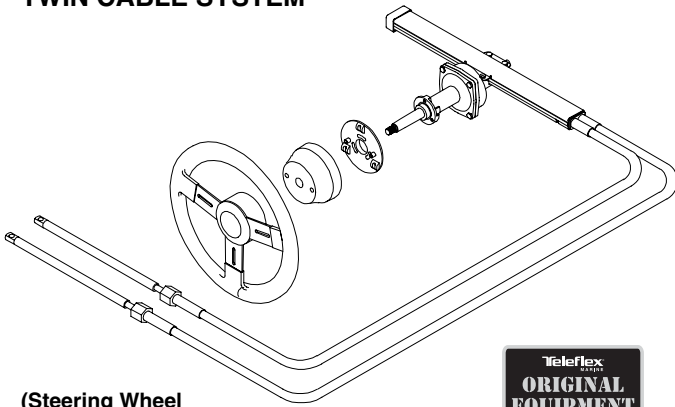

premium
outboard steering

PRO RACK NFB™
TWIN CABLE SYSTEM



(Steering Wheel
not included.)



(4 turns lock-to-lock)

**NEW VERSIONS OF TILT
COMING SOON!
(Contact Teleflex Marine
for Details.)**

NOTE: When properly installed, this steering system will connect to engines with ABYC standard tilt tubes, using engine manufacturer's link arm. For other engines, see Steering Connection Kits section for options. **NFB is not for use with power-assisted steering or autopilots.**

The only Rack and Pinion steering system for the high performance boater. Teleflex combines its patented No FeedBack technology with the incredible precision and control of a dual cable rack and pinion system. Now more than ever, NFB means performance! Teleflex offers Pro Rack for high performance hulls and motors — boats which have engine flutter, experience instability or simply need that extra margin of control at the helm. **It's a drop-in replacement for Teleflex "The Rack" and Morse Command 200 systems.**

Applications:

NFB Pro Rack systems are suitable for single-station, high performance boats equipped with a single non-power-assisted outboard (up to V-6) in which engine flutter or steering instability is present. NFB Pro Rack accepts wheels up to 16" diameter.

New Back Mount design installs easily and replaces standard Teleflex rack steering without dash modifications.



Features:

- Patented No FeedBack™ Steering mechanism.
- Dual cables minimize lost motion in system.
- Precise feel of 4 turns from lock-to-lock.
- Minimal clutch free play.
- Standard 3/4" round tapered steering shaft.
- Stainless steel cable output ends.
- Fast, easy installation; back mount design allows quick placement in dash **PLUS** mounting hardware fits industry-standard Teleflex and Morse rack holes.
- Kits include: cable, helm, 90° bezel and hardware.
- Meets A.B.Y.C. standards.
- Meets N.M.M.A. certification requirements.

2-cable mechanical rack steering, non-power-assisted boats

Complete Systems:

NFB Pro Rack Steering Kit
(Dual Cable) SS152XX

(Kits available with steering cable lengths from 12-16 feet. If either a longer or shorter cable is required, please order your system by components, which are listed below.)

Components:

NFB Rack Helm (single/dual) SH5230P

Rack Dual Cable SSC135XX
(XX = cable length in feet. A 14' SSC135 would be SSC13514.)

Rack NFB Bezel (90°) SB39544P

Options:

NFB Rack Tilt Dash Module SH1535230
Includes tilt helm and mechanism. Easy way to upgrade to Tilt or replace older Tilt systems. Requires SSC135 cable.

NFB Rack Tilt Helm (single/dual)..... SH91630P*
** Requires SH91500 tilt mechanism to complete Tilt Steering system installation.*

Performance Tilt Mechanism SH91500P

Dash Wedge Kit (10°)..... SB27448P

Dash Wedge Kit (20°)..... SB27449P

Cable Gard (fits most tilt tubes) SA39329P

Service Items:

Steering Wheel Hardware Kit 2745417P

NFB PRO RACK DUAL CABLE STEERING KIT



SH5230P

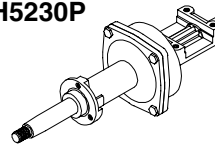

SB39544P

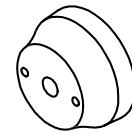

SSC135XX

(below: bottom view showing twin cable)



SH1535230
TILT DASH
MODULE

SH91630P

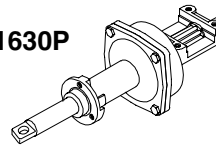

SH91500P

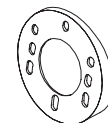
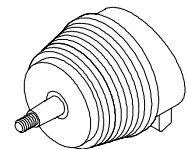

SB27448P

SB27449P

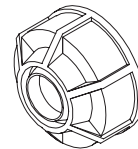
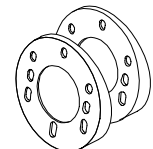

SA39329P



2745417P

NOTE: Teleflex rack cables SSC134XX, SSC135XX and SSC154XX DO NOT replace the SSC124XX or any Morse Rack & Pinion cables and can only be used with current generation Teleflex Rack & Pinion helms.