

Morse S/Twin S controls

Morse®



*(single-function control
— each lever controls
throttle OR shift)*

The original, classic Morse control – great for inboards, single or dual station. The time-proven design of Twin S means years of reliable operation. Accepts universal control cables. Optional lever extension, detent kits and neutral safety switch available. Additional hardware is required for twin station use.

(accepts these cables:)

OEM/Univ. 3300/33C Types



Universal 3300/33C Types



Universal 4300/43 Types



Applications:

Ideal for inboards, stern drives and outboards, the S controls are suitable for single or dual station use. These single function engine controls are available in both one or two-lever models.

Both S controls use 3300/33C and 4300/43 type cables. Not suitable for use with Mercury® and OMC® OEM type control cables.

Features:

- Highly polished corrosion resistant stainless steel cover.
- Simple, rugged, compact design.
- Easily adjustable throttle friction and shift detent feel.
- Optional neutral safety switch to prevent starting in gear.
- Optional hand lever extension.
- Optional shift detent kit (if used in dual stations; use on main station only).
- Uses 3300/33C and 4300/43 type cables.
- Mechanical advantage - shift 2.77:1/throttle 2.77:1.
- Meets/exceeds all applicable industry standards.

NOTE: When properly installed, these engine controls will connect to outboard, stern drive and inboard engines, utilizing universal 3300/33C and 4300/43 type cables and engine connection kits. (These controls are not designed to use Mercury/Mariner® and OMC® OEM type control cables that have “eye” terminals at the control end of the cable.)

(May require purchase of cable connection kit(s) to complete control system installation.)

mechanical control, most engines, single & dual stations

Engine Controls:

- Single S.....031002-001
- Twin S.....031001-001

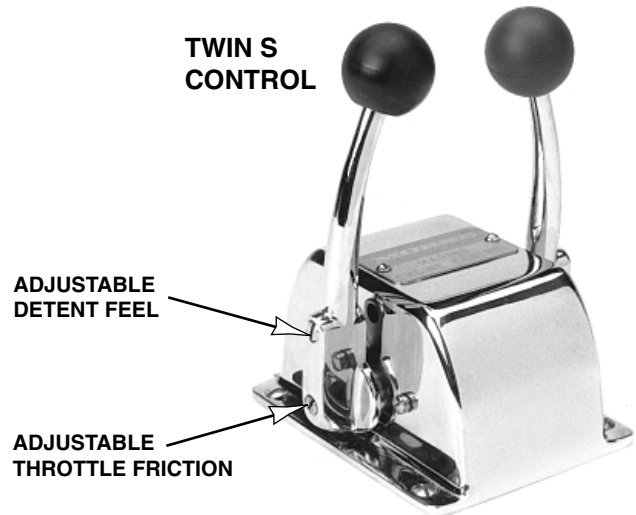
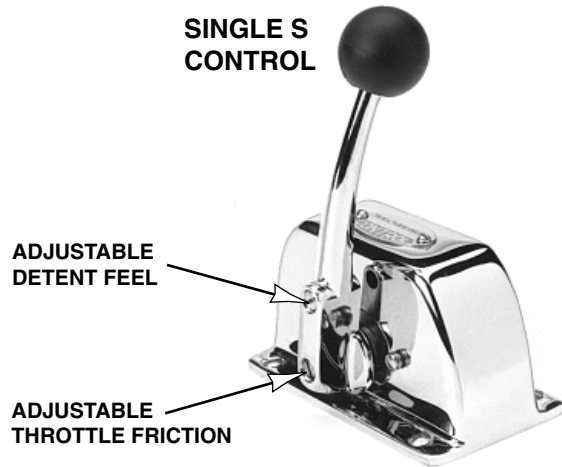

Options/Service Items:

- Clutch Detent Kit..... 022328
- In-Series Dual Station Kit, 30 Series
(2 required for twin) 039489-002
- In-Series Dual Station Kit,
40 Series (2 required for twin) 042152
- Neutral Safety Switch Kit..... 047307
- OMC Replacement Shift Switch Only..... 301585
- Lever Extension..... 036773
- Throttle Hold Kit (one per lever,
prevents throttle creep)..... 306997
- Ball Knob, Red..... 4009912
- Ball Knob, Black 4009819
- Stainless Steel Throttle Knob
(grooved) CA69052P**
- Stainless Steel Shift Knob
(smooth) CA69051P**
- ** Fits most controls with 3/8-24 threaded levers.
- Mounting Hardware Kit, Twin..... 061001
- Connection Kits .. (see Connection Kits section)

4009912

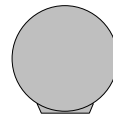

4009819



CA69052P



CA69051P

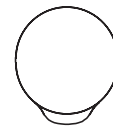

Morse Twin SR control

Morse®

*(single-function control
— each lever controls
throttle OR shift)*



(accepts these cables:)

OEM/Univ. 3300/33C Types



Universal 3300/33C Types



Universal 4300/43 Types



Ideal for inboards and multiple station boats, SR Twin is rugged and made with the finest marine grade materials. Removable cover enables easy access to the mechanism. Includes adjustable brakes and stops. Accepts universal control cables. Optional detent kits and neutral safety switch available. Additional hardware is required for twin station use.

Applications:

Ideal for inboards, stern drives and outboards, Twin SR controls are suitable for single or dual stations and can utilize 3300/33C or 4300/43 type cables.

Not suitable for use with Mercury® and OMC® OEM type control cables.

Features:

- Polished stainless steel cover, marine grade chrome levers and rugged cast hanger plate.
- Removable cover enables easy access to the control mechanism.
- Adjustable brakes and stops.
- Optional neutral safety switch to prevent starting in gear.
- Optional shift detent kit (if used in dual stations; use on main station only).
- Uses 3300/33C and 4300/43 type cables.
- Mechanical advantage - shift 3.10:1/throttle 3.10:1.
- Meets/exceeds all applicable industry standards.

NOTE: When properly installed, these engine controls will connect to outboard, stern drive and inboard engines, utilizing universal 3300/33C and 4300/43 type cables and engine connection kits. (These controls are not designed to use Mercury/Mariner® and OMC® OEM type control cables that have “eye” terminals at the control end of the cable.)

(May require purchase of cable connection kit(s) to complete control system installation.)

mechanical control, most engines, single & dual stations

Engine Control:

Twin SR 2-lever control 036469-001

Options/Service Items:

Clutch Detent Kit..... 036774

In-Series Dual Station Kit, 30 Series
(2 required for twin lever control)..... 039490-002

In-Series Dual Station Kit,
40 Series (2 required for twin) 048501-002

HD Conversion Kit
(2 required for twin lever control)..... 040090

Neutral Safety Switch Kit.....041117

OMC Replacement Shift Switch Only..... 301585

Hand Lever 036326

Ball Knob, Red..... 4009912

Ball Knob, Black 4009819

Stainless Steel Throttle Knob
(grooved) CA69052P**

Stainless Steel Shift Knob
(smooth) CA69051P**

** Fits most controls with 3/8-24 threaded levers.

Replacement Stainless Steel Lever CA69060P

(Fits Teleflex® CH5600 SLT and Morse® Twin SR controls only.)

Mounting Hardware Kit, Twin..... 060991

Replacement Dome Cover, Twin 047682

Connection Kits .. (see Connection Kits section)



4009912

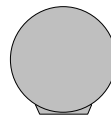

4009819



CA69052P



CA69051P



CA69060P



Morse CH5600 SLT control

Morse®



premium engine control

(accepts these cables:)

OEM/Univ. 3300/33C Types



Universal 3300/33C Types



NOTE: When properly installed, these engine controls will connect to outboard, stern drive and inboard engines, utilizing universal 3300/33C type cables and engine connection kits. (These controls are not designed to use Mercury/Mariner® and OMC® OEM type control cables that have “eye” terminals at the control end of the cable.)

(May require purchase of cable connection kit(s) to complete control system installation.)

The CH5600 SLT is a drop-in replacement for Morse® Twin SR controls.

*(single-function control
— each lever controls
throttle OR shift)*

There's nothing else like it! Patented **Self Locking Throttle** technology makes the SLT the only control that stops cable creep and works flawlessly in single or multi-station applications. SLT stops unwanted control cable movement without the need for cable brakes or other friction devices that cause poor feel at the lever and negate the performance advantages of TFXTRIME® cables. Additional hardware is required for twin station use.

Applications:

For single or dual stations with single or twin engines (one control per engine per station utilizing an optional neutral safety switch kit).

Uses 3300/33C type universal control cables.

Not suitable for use with Mercury® and OMC® OEM type control cables.

Features:

- Patented SLT technology prevents throttle creep. Lever stays where it is placed.
- Superior twin station performance.
- Polished Stainless Steel levers & dome.
- Positive detent for shifts.
- Can be user-configured as either Push or Pull to operate throttle and/or shift.
- Includes hardware for two 3300/33C type universal control cables.
- Easy-access adjustable shift detents/lever stops (under easily removable dome).
- Optional neutral safety switch.
- Meets/exceeds all applicable industry standards.

mechanical control, most engines, single & dual stations

Engine Control:

SLT Top Mount Control..... CH5600P

CH5600P

Use **TFXTREME**
Cables With This
Control

EASY ACCESS
UNDER DOME
(remove screw
near each lever)

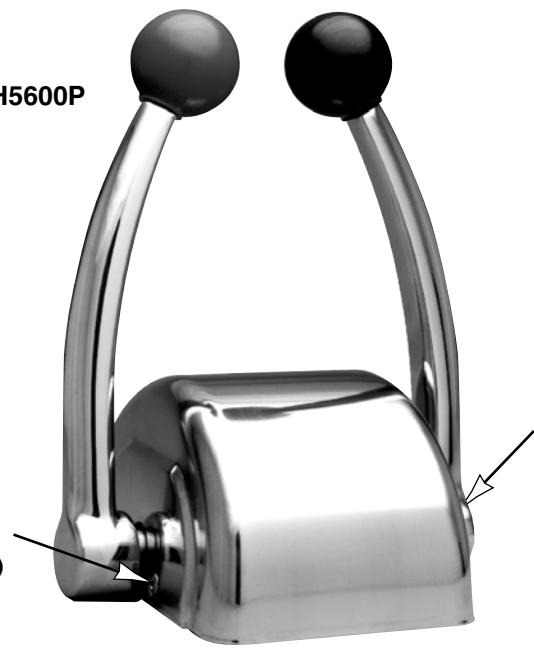

Options/Service Items:

Optional Neutral Safety Switch.....CA69009P

Cable Attachment Kit
(3300/33C Dual Station).....CA69022P

3300/33C Heavy Duty
Brass Pivot Kit (2).....CA27563P

Replacement Red Knob 4009912

Replacement Black Knob 4009819

Stainless Steel Throttle Knob
(grooved).....CA69052P**

Stainless Steel Shift Knob
(smooth).....CA69051P**

** Fits most controls with 3/8-24 threaded levers.

CH5600 Mounting Hardware Kit.....CA69013P
(Includes control mounting hardware.)

(For replacement detent balls and springs, order CA68057P
Hardware Kit for the CH4400 control.)

Replacement Stainless Steel Lever...CA69060P
(Fits Teleflex® CH5600 SLT and Morse® Twin SR controls only.)

Connection Kits .. (see Connection Kits section)

CA69009P

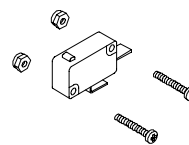

CA69022P

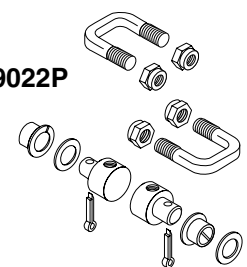

CA27563P

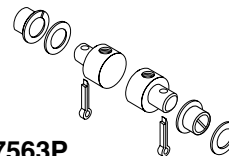

4009912

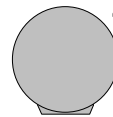

4009819



CA69052P



CA69051P

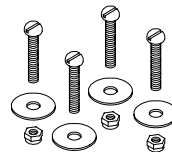
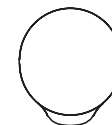

CA69013P

CA69060P



Morse CH4400 series controls

Morse®

*(single-function control
— each lever controls
throttle OR shift)*



This stylish, low profile top mount control features twin levers/single action with visual and tactile throttle/shift identification. Available in chrome or satin black, with straight or raked handles and smooth or ratchet-type friction, it can be used for single or twin stations. CH4400s accept 3300/33C type control cables and are ideal drop-in replacements for older Teleflex CH4500/4800 units. Additional hardware is required for twin station use.

(accepts these cables:)

OEM/Univ. 3300/33C Types



Universal 3300/33C Types



Applications:

For single or dual station applications with single or twin engines (one control per engine per station utilizing an optional neutral safety switch kit). Uses 3300/33C type universal control cables. *Not suitable for use with Mercury® and OMC® OEM type control cables.*

Features:

- Dual lever, single action for throttle & shift.
- Dual station capability.
- Stylish look with either straight or raked handles.
- Positive detent for shifts.
- Push or Pull to operate throttle and/or shift.
- Includes hardware for two 3300/33 control cables.
- Optional neutral safety switch.
- Adjustable traditional resistance feel or ratchet action for precise throttle operation.
- Removable knobs for recessed mounting.
- Meets/exceeds all applicable industry standards.

NOTE: *When properly installed, these engine controls will connect to outboard, stern drive and inboard engines, utilizing universal 3300/33C type cables and engine connection kits. (These controls are not designed to use Mercury/Mariner® and OMC® OEM type control cables that have “eye” terminals at the control end of the cable.)*

(May require purchase of cable connection kit(s) to complete control system installation.)

mechanical control, most engines, single & dual stations

Engine Controls:

ITEM DESCRIPTION	FINISH	HANDLES	FRICTION	PART #	NOTES
CH4400 CHROME:					
CH4451	Chrome	Straight	Smooth	CH4451P	Throttle Friction/Shift Detent
CH4452	Chrome	Straight	Ratcheting	CH4452P	Throttle Friction/Shift Detent
CH4481	Chrome	Raked	Smooth	CH4481P	Throttle Friction/Shift Detent
CH4482	Chrome	Raked	Ratcheting	CH4482P	Throttle Friction/Shift Detent
CH4400 BLACK:					
CH4453	Chrome	Straight	Smooth	CH4453P	Throttle Friction/Shift Detent
CH4454	Chrome	Straight	Ratcheting	CH4454P	Throttle Friction/Shift Detent
CH4483	Chrome	Raked	Smooth	CH4483P	Throttle Friction/Shift Detent
CH4484	Chrome	Raked	Ratcheting	CH4484P	Throttle Friction/Shift Detent
NOTES:					
The adjustable smooth (resistance type) and ratcheting friction features are for use with throttle control only. Use detents without friction for shift. If application is twin station, use detents on lower station only.					
QUESTIONS? CALL TECH SUPPORT AT 610-495-7011, EXT. 2.					

CH4451P/
CH4452P



CH4481P/
CH4482P



EASY ACCESS
COVER PLATE
(for lever friction
adjustment)

CH4453P/
CH4454P



CH4483P/
CH4484P



Options/Service Items:

Optional Neutral Safety Switch.....CA68075P

3300 Heavy Duty Brass Pivot Kit (2) .CA27563P

CH4400 Dual Station Hardware Kit...CA68065P

This kit is for use with 3300/33C type universal cables only.

CH4400 Hardware Kit.....CA68057P

CH4400 Cover (Black Plastic) 6800611

CH4400 Cover (Stainless Steel)..... 6800618

CH4400 Knob (Chrome Zinc Alloy) 6801812

CH4400 Knob (Black Aluminum) 6801811

CH4400 Knob (Red Aluminum) 6801815

CH4400 Screw for Knob..... 6801918

CH4400 Black Knob Cap (Shift)..... 6802215

CH4400 Red Knob Cap (Throttle)6802111

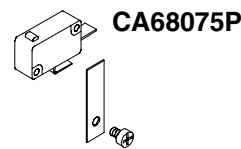

CA68075P

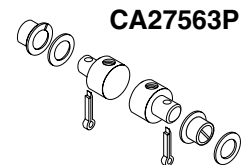

CA27563P

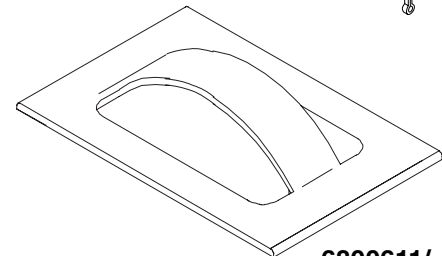

6801812/
6801811/
6801815
(1 knob)

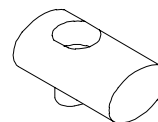

6800611/
6800618

6802215



6801918



6802111

CONTROLS single function

Morse MY controls

Morse®



*(single-function control
— each lever controls
throttle OR shift)*

An incredible blend of form, function and flexibility. Exciting styling, smooth operation and rugged, compact form make the MY ideal for many applications, especially the control of multiple engines. MY gives you a vast array of control choices which add style to any cockpit, yet occupy a minimum amount of space.

(accepts these cables:)

OEM/Univ. 3300/33C Types



Universal 3300/33C Types



Applications:

For single, twin, triple and quad engines (including outboards utilizing an optional neutral safety switch kit). Ideal for multiple engine control. MY controls are for single station use.

Uses 3300/33C type universal cables.

Not suitable for use with Mercury® and OMC® OEM type control cables.

Features:

- Available in two, four, or six lever configurations; levers available in either fore- or aft-canted positions.
- Levers available in black, satin and polished stainless steel finishes.
- Positive shift detents.
- Smooth ratchet throttle or optional adjustable throttle brake.
- Neutral safety switch to help prevent starting in gear.
- Uses 3300/33C type universal control cables.
- Mechanical advantage - shift 2.14:1/throttle 3.03:1.
- Meets/exceeds all applicable industry standards.

NOTE: *When properly installed, these engine controls will connect to outboard, stern drive and inboard engines, utilizing universal 3300/33C type cables and engine connection kits. (These controls are not designed to use Mercury/Mariner® and OMC® OEM type control cables that have “eye” terminals at the control end of the cable.)*

(May require purchase of cable connection kit(s) to complete control system installation.)

mechanical control, most engines, single stations

Engine Controls:

**MY (ST)
SINGLE SHIFT,
SINGLE THROTTLE
(aft cant shown)**



**MY (SSSTTT)
TRIPLE
SHIFT,
TRIPLE
THROTTLE
(aft cant
shown)**



"S" & "T" in the "lever placement" column of chart refer to relative placement of throttle & shift levers.

ITEM DESCRIPTION	# OF LEVERS	LEVER PLACEMENT	THROTTLE FRICTON	LEVER COLOR	LEVER CANT	HOUSING COLOR	PART #
MY (1 AFT-CANTED LEVER):							
MY (1 Throttle)	1	T	Ratcheting	Black	Aft	Black	311110-420
MY (2 AFT-CANTED LEVERS):							
MY (1 Shift, 1 Throttle)	2	ST	Ratcheting	Black	Aft	Black	311111-460
MY (1 Shift, 1 Throttle)	2	ST	Ratcheting	Black	Aft	White	311109-460
MY (2 Throttle)	2	TT	Ratcheting	Black	Aft	Black	311120-460
MY (2 Shift)	2	SS	F-N-R detents	Black	Aft	Black	311193-460
MY (1 Shift, 1 Throttle)	2	ST	Ratcheting	Stainless	Aft	Black	311111-560
MY (1 Shift, 1 Throttle)	2	ST	Resistance	Stainless	Aft	Black	311111-521
MY (2 FORWARD-CANTED LEVERS):							
MY (1 Shift, 1 Throttle)	2	ST	Resistance	Black	Forward	Black	311111-161
MY (1 Shift, 1 Throttle)	2	ST	Ratcheting	Satin	Forward	Black	311111-270
MY (1 Shift, 1 Throttle)	2	ST	Resistance	Satin	Forward	Black	311111-261
MY (4 AFT-CANTED LEVERS):							
MY (2 Shift, 2 Throttle)	4	STTS	Ratcheting	Black	Aft	Black	311122-460
MY (2 Shift, 2 Throttle)	4	SSTT	Ratcheting	Black	Aft	Black	311188-460
MY (2 Shift, 2 Throttle)	4	SSTT	Resistance	Black	Aft	Black	311188-461
MY (2 Shift, 2 Throttle)	4	STTS	Ratcheting	Stainless	Aft	Black	311122-560
MY (2 Shift, 2 Throttle)	4	STTS	Ratcheting	Satin	Aft	White	311113-560
MY (2 Shift, 2 Throttle)	4	SSTT	Ratcheting	Satin	Aft	White	311118-560
MY (4 FORWARD-CANTED LEVERS):							
MY (2 Shift, 2 Throttle)	4	SSTT	Resistance	Stainless	Forward	White	311118-261
MY (6 AFT-CANTED LEVERS):							
MY (3 Shift, 3 throttle)	6	SSSTTT	Ratcheting	Black	Aft	Black	311133-460
MY (3 Shift, 3 throttle)	6	SSSTTT	Ratcheting	Stainless	Aft	Black	311133-560
MY (6 FORWARD-CANTED LEVERS):							
MY (3 Shift, 3 throttle)	6	SSSTTT	Resistance	Black	Forward	Black	311133-151
NOTES:							
Bold digit in P/N relates to direction engine levers move when control lever is moved forward. See also below.							
The adjustable smooth (resistance type) and ratcheting friction features are for use with throttle control only.							
Models with resistance-type throttle friction include brake. Ratcheting throttle models do not.							
QUESTIONS? CALL TECH SUPPORT AT 941-907-1000, EXT. 8222.							

Options/Service Items:

MY Mounting Screws - Black.....306047
 MY Pivot Kit (Single Cable) 306048-001
 MY Pivot Kit (Two Cables)..... 306048-002

MY Neutral Safety Switch Kit.....306594
 MY Detent & Spring Kit.....306595
 MY Throttle Friction Kit (1 per throttle lever)...306615

Number Code:

Because there are many combinations available with the MY Control, a part numbering system has been developed to help you identify the part number of the control configurations available. Please note the three numbers following the base number to order the required control.

3 1 1 1 ? ? **X X X**

base number

HANDLE ORIENTATION/FINISH:
 1 - Black; Forward Cant
 2 - Satin or Stainless; Fwd. Cant
 4 - Black; Aft Cant
 5 - Satin or Stainless; Aft Cant

PUSH/PULL SELECTION:
 2 - Pull to Open, All Throttle Levers
 5 - Push to Open Throttle/Pull into Forward Gear
 6 - Pull to Open Throttle/Pull into Forward Gear
 7 - Push to Open Throttle/Push into Forward Gear
 (This refers to the direction that lever(s) on the engine and/or transmission move with forward movement of the control handle.)

THROTTLE FRICTION:
 1 - Resistance throttle with friction brake, no throttle detents
 0 - Ratchet throttle has throttle detents without friction brake

CONTROLS single function

Morse ST/STB controls

Morse®

*(single-function
single-lever control)*



The ST & STB controls are economical, and durable, with a simple, classic design. Single-function lever moves one cable only. Versions are available for 3300/33C and 4300/43 type cables, with or without external, adjustable throttle brake.

(accepts these cables:)

OEM/Univ. 3300/33C Types



Universal 3300/33C Types



Universal 4300/43 Types



Applications:

The STB control includes a throttle brake and can shift Berkeley® or similar type jets when a foot throttle is used.

ST/STB units can utilize 3300/33C type universal control cables.

ST-HD and STB-HD controls use 4300/43 type control cables.

ST/STB controls are for single-station use only and are not suitable for use with Mercury® and OMC® OEM type control cables.

Features:

- Compact, rugged design and classic traditional styling.
- Durable heavy chrome finish.
- Models for 3300/33C and 4300/43 type cables.
- Available with or without adjustable external throttle brake.
- Mechanical advantage - 3.20:1.

NOTE: When properly installed, these engine controls will connect to inboard engines, utilizing universal 3300/33C and 4300/43 type cables and engine connection kits. (These controls are not designed to use Mercury/Mariner® and OMC® OEM type control cables that have "eye" terminals at the control end of the cable.)

(May require purchase of cable connection kit(s) to complete control system installation.)

mechanical control, several engine types, single station

Engine Controls:

ST CONTROLS (NO BRAKE):

ST Control (3300/33C type cables) 031791

ST-HD Control (4300/43 type cables)..... 039115

STB CONTROLS (WITH BRAKE):

STB w/external brake
(3300/33C type cables) 044777

STB-HD w/external brake
(4300/43 type Cables) 045978

ST



STB



ADJUSTABLE
THROTTLE FRICTION

Options/Service Items:

Hand Lever Assembly, Chrome 031046-002

Ball Knob, Black
(replaces 035232-044) 4009819

Stainless Steel Shift Knob
(smooth) CA69051P**
** Fits most controls with 3/8-24 threaded levers.

Throttle Cable Brake..... 044386

Mounting Hardware Kit
(30 Series Kit)..... 062279

4009819



CA69051P

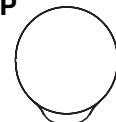

CONTROLS single function

Morse MJB controls

Morse®

*(single-function
two-lever control)*



(accepts these cables:)

OEM/Univ. 3300/33C Types



Universal 3300/33C Types



Universal 6400/64 Types



NOTE: When properly installed, these engine controls will connect to inboard engines, utilizing universal 3300/33C and 6400/64 type cables and engine connection kits. (These controls are not designed to use Mercury/Mariner® and OMC® OEM type control cables that have “eye” terminals at the control end of the cable.)

(May require purchase of cable connection kit(s) to complete control system installation.)

The MJB control is ideal for sailboats, inboards and sterndrives with hard to shift transmissions. An extra long shift handle provides ample leverage. The shorter handle controls the throttle. The MJB uses 3300/33C type cables for throttle and heavy duty 6400/64 type cables for shift.

Applications:

The MJB control is a great choice for many inboards, stern drives, sailboats and Berkeley® or similar type jets. 3300/33C type universal control cables can be used for throttle; 6400/64 type control cables can be used for shift. MJB controls are for single-station use only and are not suitable for use with Mercury® and OMC® OEM type control cables.

Features:

- Compact, rugged design and classic traditional styling.
- Separate handles for throttle and shift. (Shift lever is long for optimal leverage with hard-to-shift transmissions.)
- Accepts 3300/33C type cables for throttle and 6400/64 type cables for shift.
- Durable heavy chrome finish.
- Includes external adjustable brake for throttle friction adjustment.
- Has detent for positive neutral feel.
- Right or left hand installation.
- Engine linkage and travel direction can be accommodated in the control.
- Mechanical advantage - Shift 3.63:1, Throttle 3.20:1.
- Meets/exceeds all applicable industry standards.

mechanical control, several engine types, single station

Engine Control:

MJB Control
(Uses 3300/33C and
6400/64 type cables)044716-001



Options/Service Items:

Hand Lever Assembly, Chrome031046-002

Ball Knob, Red..... 4009912

Ball Knob, Black
(replaces 035232-044) 4009819

Stainless Throttle Knob (grooved) ..CA69052P**

Stainless Steel Shift Knob
(smooth)CA69051P**

** Fits most controls with 3/8-24 threaded levers.

Neutral Safety Switch 47346

Mounting Hardware Kit
(30 Series Kit)..... 062279

